

Every resident must sign a rental agreement upon arrival and comply with the rules of procedure of the Campus.

Entry and exit inventories are carried out.

All residents must provide proof of health and civil liability insurance covering them in France and for the whole duration of their stay in the Campus, as well as proof of home insurance (to be subscribed in a bank or an insurance company upon arrival).

## The Studios



The new residence of the Mediterranean campus offers three types of spacious, comfortable and fully equipped studios offering various services. The studios are designed for one occupier.



### **(S1) Single studio of 23 m<sup>2</sup>**

containing a single bed, a bedside with a lamp, a cabinet with clothes closet, a desk with a mobile storage box, a seat, a bookcase, a kitchen equipped with two hobs, a fridge, a table with two chairs, a side table on wheels, furniture elements above and under the kitchen sink.

The studio is also equipped with a bathroom and toilets.

### (S2) Double studio of 33 m<sup>2</sup>

composed of two individual rooms and of a common room containing a bathroom, toilets and an equipped kitchen: two hobs, a fridge, a table with two chairs, a furniture piece above the kitchen sink.

Each room is fully equipped: a single bed, a bedside with a lamp, a cabinet with clothes closet, a desk with a mobile storage box, a seat, a bookcase.

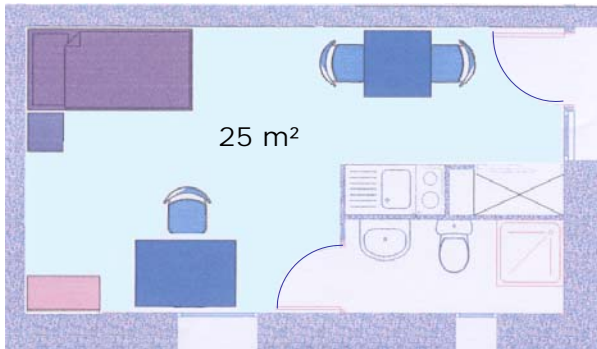

### (S3) Single studio of 25 m<sup>2</sup>

accessible to people with reduced mobility

It is equipped of a single bed, a desk, a seat, a bookcase, a table and two chairs. The studio also contains a bathroom with toilets and a kitchen equipped with two hobs and a fridge.

## Booking

The single studios are designed for one occupier only. To benefit from a studio, you must fill in a booking form. If the demand is accepted, you will have to pay a deposit of 300 € (for an individual room in a S2 type of studio) or 400 € (for a S1 or S3 type of studio) to effectively confirm the booking. You will then receive a confirmation letter specifying the dates of your stay.

## Services included in the rent

- Linen supply and laundering: sheets, blankets, towels, etc.
- Daily disposal of garbage
- Maintenance assistance in case of technical problems
- Mail distribution
- Access to Internet (on demand)
- Availability of a self-service laundry (not free)
- Connexion for television (22 free channels)

Mediterranean Agronomic Institute of Montpellier

3191, route de Mende, 34093 Montpellier cedex 5 - France

+33 (0)4 67 04 60 00 - resacampus@iamm.fr

www.iamm.fr

# The Villa Mediterra



The Villa Mediterra is composed of 8 studios offering the possibility to host our CIHEAM-IAMM partners as well as new visitors.

- 2 studios on the ground floor which are accessible to people with reduced mobility
- 3 studios on the first floor with entrance door
- 3 studios on the first floor with bay windows



**The studios (24 m<sup>2</sup>)** are individual, fully equipped and furnished (with a double bed): kitchen with heating plates, mini fridge, small electrical household (microwave, coffee maker), dishes, cooking utensils, private bathroom with toilets, television, internet connection.

Every resident is invited to use the collective room of the villa at the ground floor where he/she will find everything necessary for breakfast.



## Booking

To benefit from a studio, you must fill in a booking form.  
For outside visitors, a deposit of 400 € must be paid.

## Services included in the rent

- Linen supply and laundering: sheets, blankets, towels, etc.
- Daily disposal of garbage
- Maintenance assistance in case of technical problems
- Mail distribution
- Access to Internet (on demand)
- Availability of a self-service laundry (not free)
- Connexion for television (22 free channels)

Mediterranean Agronomic Institute of Montpellier

3191, route de Mende, 34093 Montpellier cedex 5 - France

+33 (0)4 67 04 60 00 - resacampus@iamm.fr

www.iamm.fr